

**ELEVATION 1**  
Scale 1:20

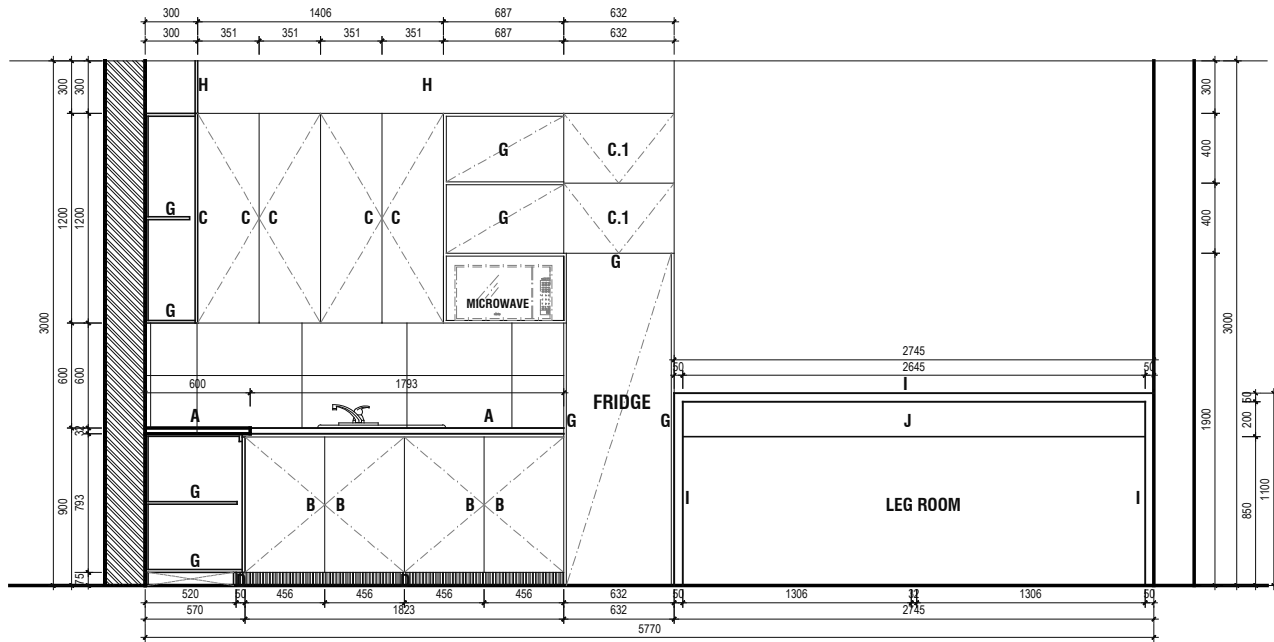

**ELEVATION 2**  
Scale 1:20

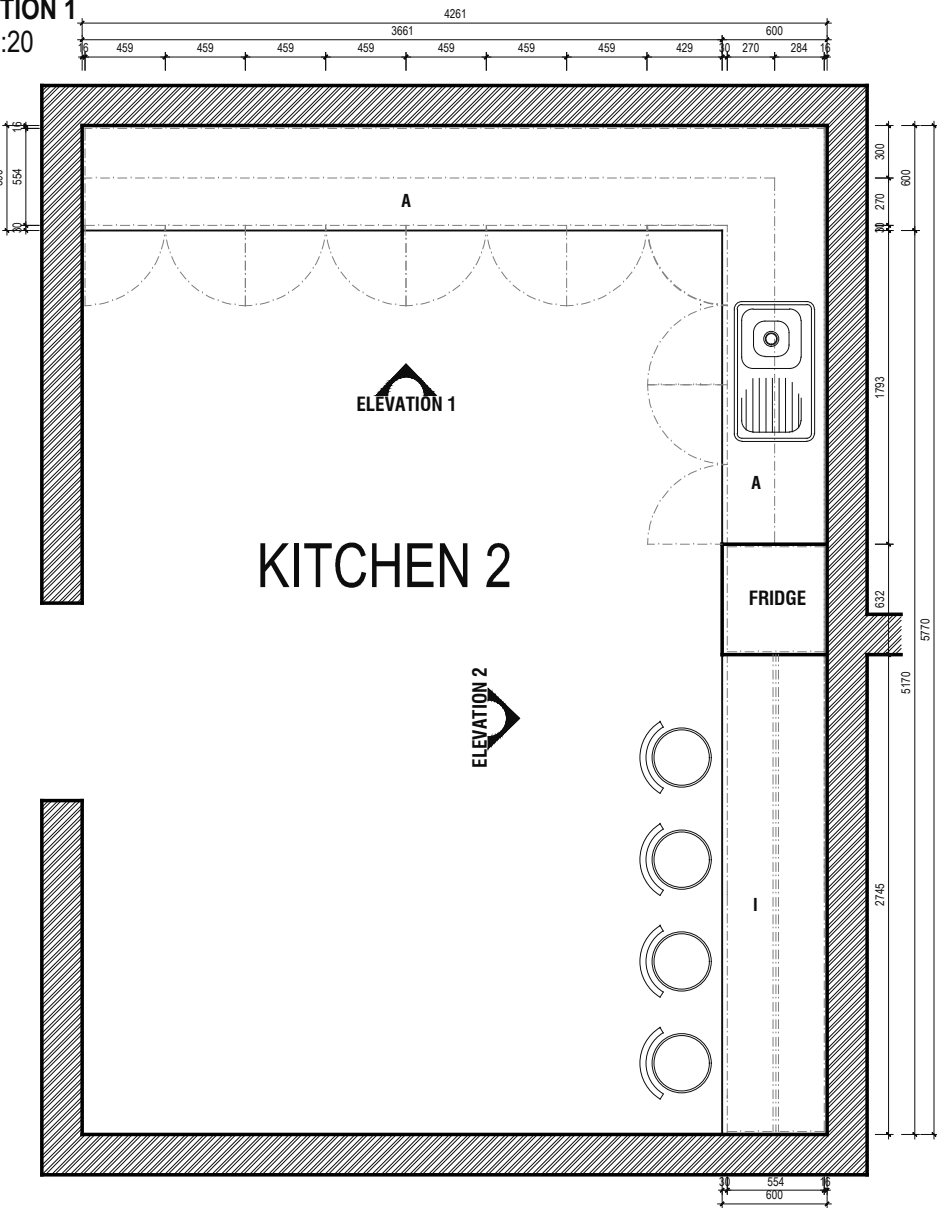

**PLAN**  
Scale 1:20



**NOTES**

**A - KITCHENETTE TOP**  
Provide a 32mm Zim Black Granite profile top surface

**B - BOTTOM CUPBOARDS**  
Provide 16mm purpose made (Fushia) Dulux RR01 Dulux 10RR 18/350 Duco Spray Painted supawood doors and fix in approved manner. Provide approved runners and hinges, by specialist. All interior carcass to be in white melamine finish. Provide bin where indicated. All kitchenettes to receive approved under counter Geysers.  
All handles to be -  
Item no: 1595  
Finger Grip 1 Flat Large Grip  
Material: Aluminium  
Code: 297mm | RAH 859

**C - TOP CUPBOARDS**  
Provide 16mm purpose white melamine supawood pull up doors and swing doors fixed in approved manner. Provide approved hinges by specialist. All interior carcass to be in white melamine finish. Provide 90° opening radius Gas Support door lift system for pull up doors.  
All handles to be -  
Item no: 1132  
Finger Grip 1 Flat Small  
Material: Aluminium  
Code: 497mm | RAH 806 / 897mm | RAH 809

**C.1 - TOP CUPBOARDS**  
Provide 16mm purpose made white melamine supawood pull up doors fixed in approved manner. Provide approved hinges by specialist. All interior carcass to be in white melamine finish.  
All handles to be -  
Item no: 1132  
Finger Grip 1 Flat Small  
Material: Aluminium  
Code: 497mm | RAH 806 / 897mm | RAH 809

**D - KICKPLATE**  
Provide approved 75mm brushed aluminum Formica kickplate and fix in approved manner.

**E - DRAWERS**  
Provide purpose made 16mm white melamine supawood drawers as indicated, fix to cupboard in approved manner, by specialist.

**F. BACKSPLASH**  
Provide 300mm x 600mm super white ceramic tile. Laid as per indicated, 1mm joint with white grout.

**G. SHELVES**  
Provide 16mm thick white melamine board shelves. Fix in approved manner.

**H. TOP PANEL**  
Provide 16mm thick white melamine board. Fix in approved manner.

**I. BAR EATING/ COUNTER TOP AND SIDE PANELS**  
Purpose made 16mm timber framework panels and top to create 50mm thick chamfered top and side panels and fix together in approved manner, by specialist.  
FINISH: SUMMER OAK LAMINATE

**J. UNDER SIDE PANEL**  
Provide 32mm white Gloss spray painted front panel where indicated and fix to top and side panels in approved manner. Note: Front panel to work as support to the bar/eating counter.

**GENERAL NOTES:**

1. NO DIMENSIONS TO BE SCALED.
2. DIMENSIONS TO BE VERIFIED ON SITE BEFORE COMMENCING ANY SITE WORK OR SHOP DRAWINGS.
3. DIMENSIONS ARE TAKEN TO CENTRE LINES OR STRUCTURAL SURFACES AND DO NOT INCLUDE FINISHES EXCEPT WHERE OTHERWISE STATED.
4. THE ARCHITECT IS TO BE NOTIFIED OF ANY DISCREPANCIES BETWEEN THIS DRAWING AND ANY OTHER DRAWING OR CONSTRUCTION DOCUMENTS INCLUDING THOSE ISSUED BY CONSULTANTS AND NOMINATED SUB-CONTRACTORS BEFORE COMMENCING WORK.
5. MINIMUM STRENGTH POF CONCRETE 21Mpa

ISSUED FOR  
**TENDER**  
PURPOSES

REV.	DESCRIPTION	DATE
5	CLIENT	
6	DWG TITLE	
7	SCALE	
	DATE	
	REV.	

**CLIENT**  
  
SOUTHERN AFRICAN  
DEVELOPMENT COMMUNITY

**JOB TITLE**  
SADC STANDBY FORCE REGIONAL  
LOGISTICS DEPOT, AT RASESA,  
GABORONE, BOTSWANA,

**DWG TITLE**  
ADMINISTRATION BLOCK  
First Floor - Kitchen 2

SCALE AS SHOWN JOB No. G649

DATE FEB 2022 DRAWN BY KM

REV. CHECKED BY AM

Project Team:  
Architect FMA Architects  
Quantity Surveyor Turner & Townsend (Pty) Ltd.  
Electrical Engineers GA Consulting Engineers (Pty) Ltd.  
Mechanical Engineers GA Consulting Engineers (Pty) Ltd.  
Civil Engineers Botswana Bureau Botswana (Pty) Ltd.  
Structural Engineers Botswana Bureau Botswana (Pty) Ltd.

**FMA** FMA ARCHITECTS (PTY) LTD.  
P.O. BOX 201504 BONTLENG  
GABORONE, BOTSWANA  
TEL: 3959812/3 FAX: 3959814  
E-MAIL: fmagab@info.bw

DRWG. No. SADC/ARCH/2/002/1-514